

CIGS Thin-Film Solar Modules

STN-125 / STN-130 / STN-135 / STN-140 Solar Modules

Stion's solar modules provide exceptional efficiency and superior performance. The modules utilize Stion's breakthrough technology, developed and manufactured in the USA by a world class team with unmatched solar expertise in thin films.

High Efficiency

Advanced proprietary copper, indium, gallium, selenium, and sulfur (CIGS) thin-film technology yields high efficiency modules.

Superior Power Performance

Low temperature coefficient and excellent shade and debris tolerance provide outstanding energy delivery per watt.

Aesthetics and Design

Black design has virtually invisible cell lines that offer superior aesthetics. The black anodized aluminum frame is compatible with most racking systems. Convenient form factor enables easy installation and more modules per rack.

Long-term Reliability

Proven glass-glass package provides a robust design for installation in a variety of environments. Backed by a 10 year workmanship warranty and a 25 year limited power warranty.

Made in the USA

All of Stion's modules are designed and manufactured in the United States under the highest quality standards.



Elevation Series solar modules are specifically designed for use in most solar applications including residential, commercial, government, utility, and off-grid projects.



Electrical Data*

Nominal Power, P _{MAX} (W)	125	130	135	140
Module Efficiency (%)	11.5%	12.0%	12.4%	12.9%
V _{mpp} (V)	41.0	42.7	44.3	45.5
I _{mpp} (A)	3.05	3.05	3.05	3.08
V _{oc} (V)	55	56.5	58.5	60
I _{sc} (A)	3.45	3.42	3.42	3.42
Series Fuse Rating (A)	6			
Maximum System Voltage (V)	600(UL) 1000 (IEC)			
Temp. Coefficient (P ^{mpp})	-0.34%/°C			
Temp Coefficient (V ^{oc})	-0.28%/°C			
Temp Coefficient (I ^{sc})	0.003%/°C			
Power Output Tolerance, P _{MAX} (W)	+ / - 2.5			
NOCT**	45.2°C			

** Normal Operating Cell Temperatures (NOCT): 800 W/m², 20°C, 1m/s wind speed

I-V Curves

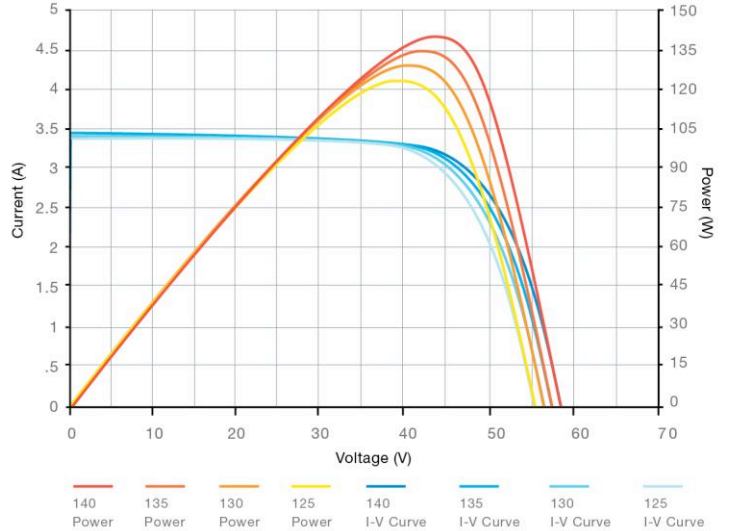

* Measured at Standard Testing Conditions (STC): 25°C, 1000 W/m², AM 1.5
All ratings are ± 10% unless noted otherwise

Mechanical Data

Width	25.8 in (656mm)
Length	65.2 in (1656mm)
Depth	1.4 in (35mm)
Weight	37.0 lbs (16.8kg)
Total Area	11.68 ft ² (1.09m ²)
Frame	Black Anodized Aluminum
Cable	14 AWG Cable 39.4 in (1m)
Connectors	MC-4 Compatible
J-Box	IP 65 rated
Cover Type	3.2mm high transmission tempered front glass laminated to 2 mm float glass

Warranty and Qualifications

Limited Power	90% at 10 years 80% at 25 years
Workmanship	10 years
Fire Resistance	Class C
Safety	Class II (IEC 61140)
Mechanical / Wind Load	2400 Pa (50 psf)

Performance at Low Irradiance

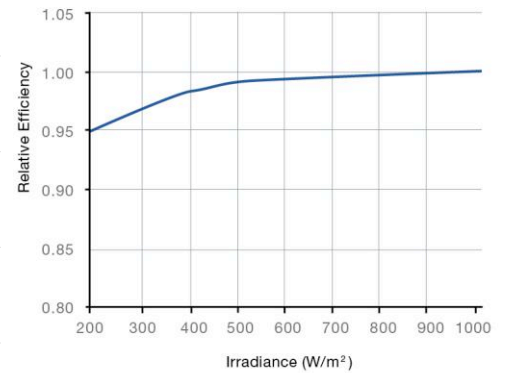

Typical relative change in module efficiency from 1000 W/m² irradiance to 200 W/m² is 5%, measured at STC.

Dimensions Inches [mm]

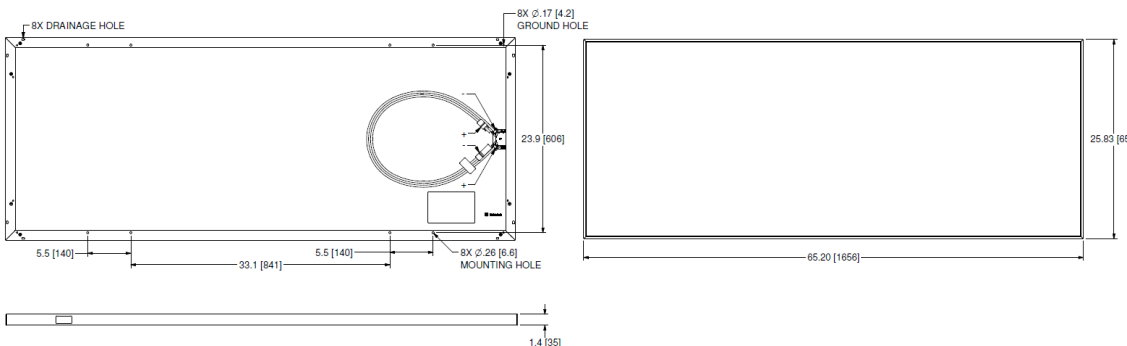

Caution! Read Safety & Installation Manual before handling, installing or operating Stion products.

Specification included in this datasheet are subject to change without notice.

